

A conceptual image featuring a transparent globe with a chrome faucet attached to its right side. The globe's landmasses are covered in green grass, while the oceans are a deep blue. Water is shown splashing from the faucet's spout, creating a dynamic sense of movement. The entire scene is set against a vibrant blue background with abstract, flowing light patterns, emphasizing the theme of water conservation and environmental stewardship.

Corrosion resistant metal
Easy to assemble
Run dry without damage
Self priming

Long life designed
Low vibration
Quiet and High efficient performance
Variety voltage version available

- Reverse Osmosis system
- Beverage system
- Domestic water system
- Sparkling system

Name	Flow
E-36	50GPD
E-100	100GPD
E-150	150GPD



<http://www.aqq.com.tw>

Dimension

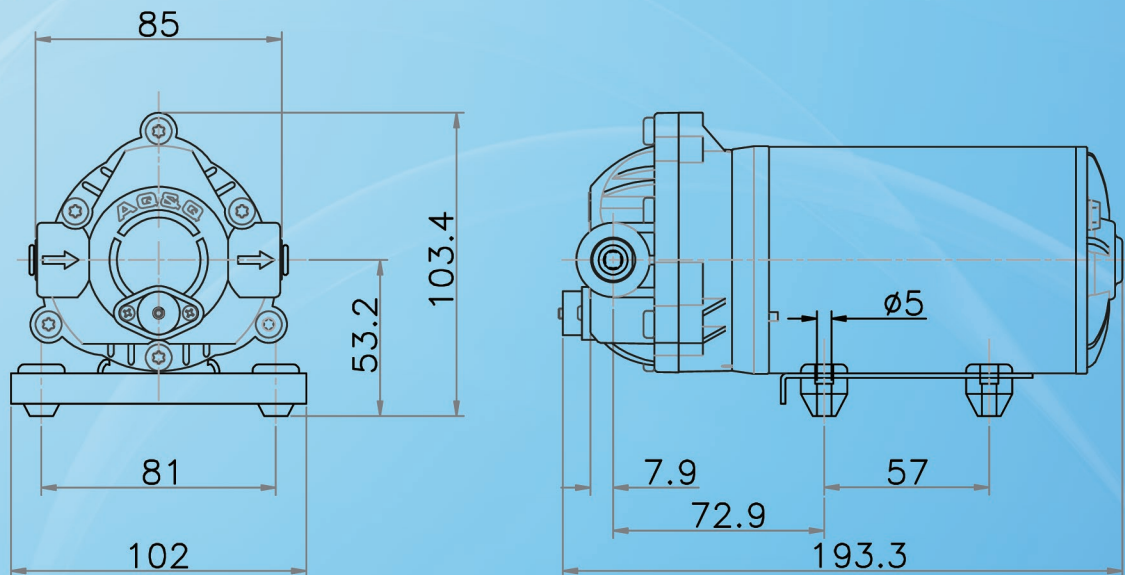

Specifications:

◎ Design	Positive displacement 3 chamber diaphragm pump
◎ Motor	Permanent magnet motors. Ball bearing drive.
◎ Voltage	24 VDC/VAC (Variety voltage available)
◎ Ports	3/8" NPT female inlet/outlet (1/4" Quick Connect available)
◎ Material	Santoprene™ & Polyamide

Flow Curve

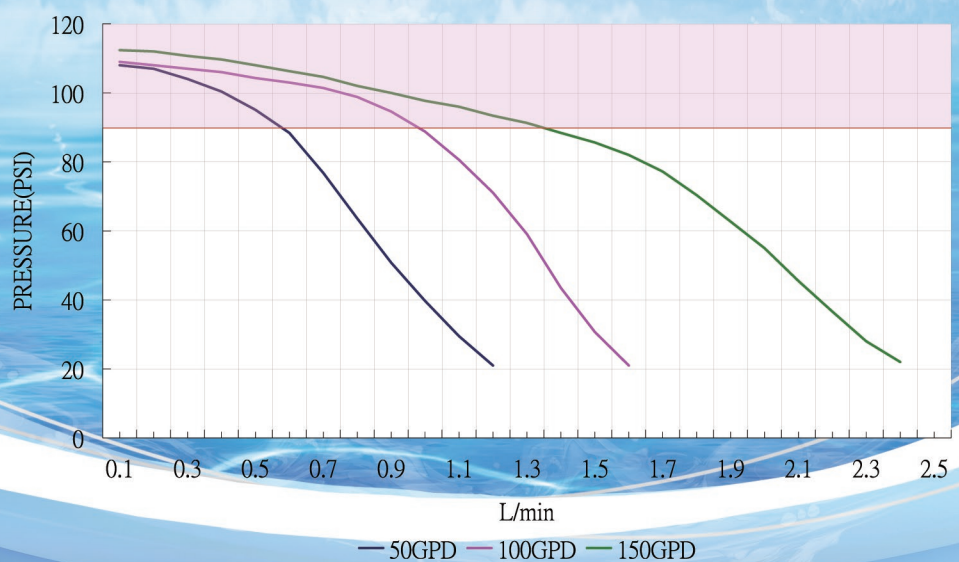

Test Condition

Inlet Pressure : 20 psi

Recommendation:

For Reverse Osmosis system application, pressure shall not over 90psi.

Note:

Technical specification sheets are available for individual model numbers, AQ&Q reserves the right to update specifications, change prices, or make substitutions without prior notice.